



2022 CAPITAL PROJECTS: LODGE PAVILION RENOVATION + MARINA DECK REHABILITATION CONCEPTUAL PLANS

April 21, 2022



TAHOE DONNERSM



TODAY'S OBJECTIVES

Staff to present the Board with the Lodge Pavilion and Marina Deck Rehabilitation updates since March 25, 2022



Tahoe Donner Lodge Pavilion Conceptual Improvement Plan

Scale: NTS

March 22, 2020

L J M
DESIGN GROUP
Landscape Architecture and Planning

Key Improvements

- Approximately 3500 SF of New Paver Patio
- Outdoor Seating for Approx. 100 Guests
- Convert Storage Shed to a Walk-up Bar
- Shade Pergola with Adjustable Roman Shades with Integrated Heating and Lighting.
- Fire-Pit Area with Seating for Approx. 26 Guests
- Refresh Lawn and Landscape
- Re-distribute Golf Cart Parking

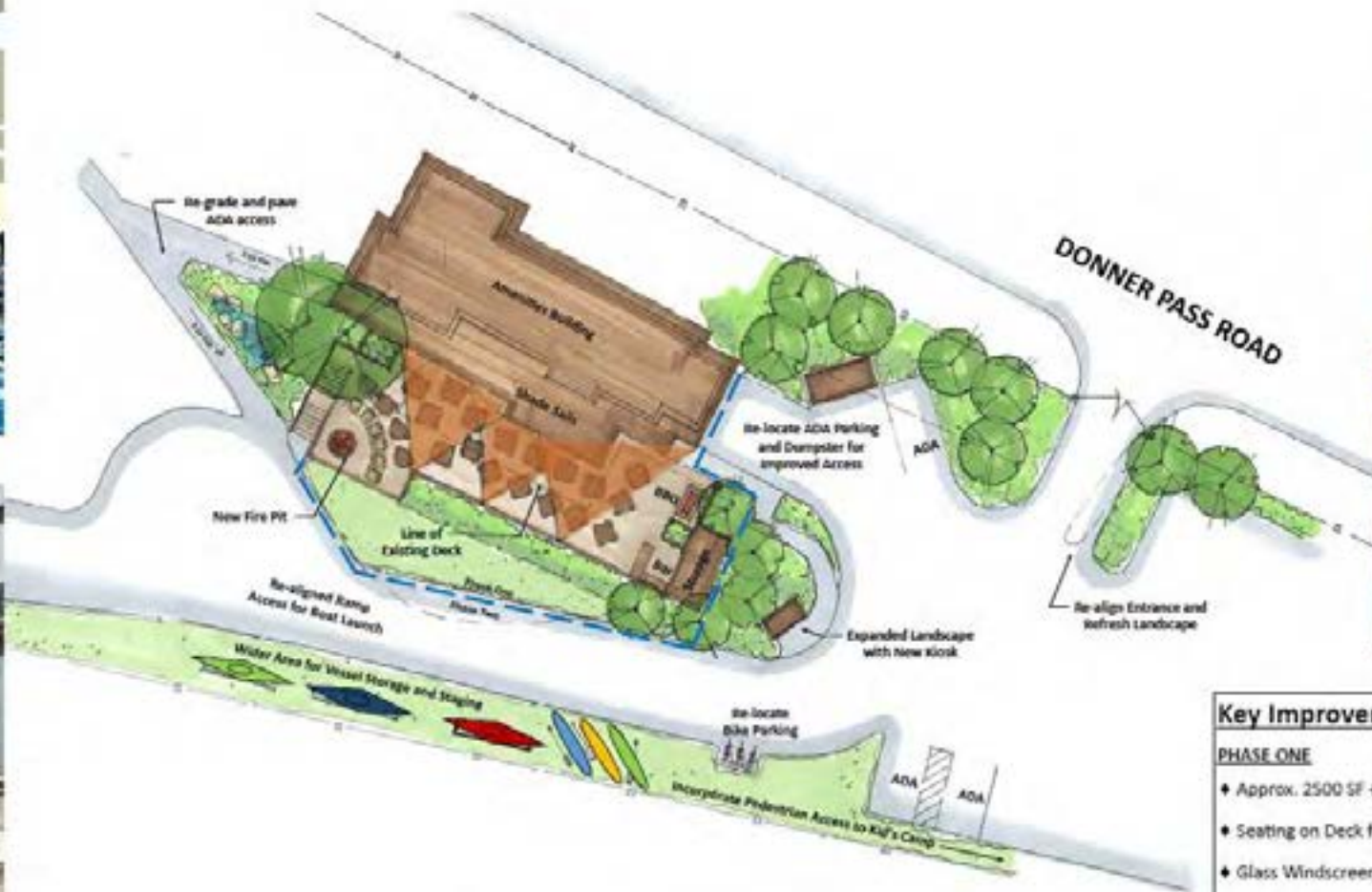

Tahoe Donner Marina Conceptual Improvement Plan

Scale: NTS

March 22, 2020

L J M

DESIGN GROUP

Landscape Architecture and Planning

Key Improvements

PHASE ONE

- ◆ Approx. 2500 SF +/- of New Deck to Match Existing.
- ◆ Seating on Deck for Approximately 80 People.
- ◆ Glass Windscreen Railing System.
- ◆ Shade Sails.
- ◆ Walk-up Bar and BBQ/Smoker Area.
- ◆ New Storage Building with Roll-up Door by Bar. Architecture in-keeping with Main Building.
- ◆ Add New ADA Ramp at West end of Dining.

PHASE TWO

- ◆ Re-align Dumpster Position for Easier Access.
- ◆ Re-locate Three Required ADA Parking Spaces.
- ◆ Expanded Landscape area at Entry and New Member Check-in Kiosk.
- ◆ Re-align Drive Entry, Launch Driveway and Widen Personal Vessel Storage and Staging Area.
- ◆ Add Access Path to Children's Camp Area.

NEXT STEPS

- Design team moves forward with planning and design development for both projects
- Anticipate construction cost estimates for both projects in May
- Lodge Pavilion construction timeline:
 - Still possible for spring construction – June
 - Will not start project if it cannot be completed by June 30, 2022
- Marina deck rehabilitation construction timeline:
 - Fall 2022



THANK
YOU



TAHOE DONNERSM