

Dist	COUNTY	ROUTE	POSTMILE
03	NEV	80	13.1

NOTES:
 1. ALL DETOUR SIGNS SHALL BE BLACK ON ORANGE UNLESS OTHERWISE SHOWN.
 2. SIGN LOCATIONS SHOWN ARE APPROXIMATE, EXACT LOCATIONS TO BE DETERMINED BY THE ENGINEER.

LEGEND:
 [Arrow] DETOUR ROUTE
 [Sign Symbol] DETOUR SIGN
 XXXX CLOSED ROAD

DONNER PASS ROAD - RAMP CLOSED
 42' x 66"
 RETROREFLECTIVE ORANGE BACKGROUND WITH BLACK LEGEND AND BORDER.

TO I-80 EAST
 12' x 48"
 RETROREFLECTIVE ORANGE BACKGROUND WITH BLACK LEGEND

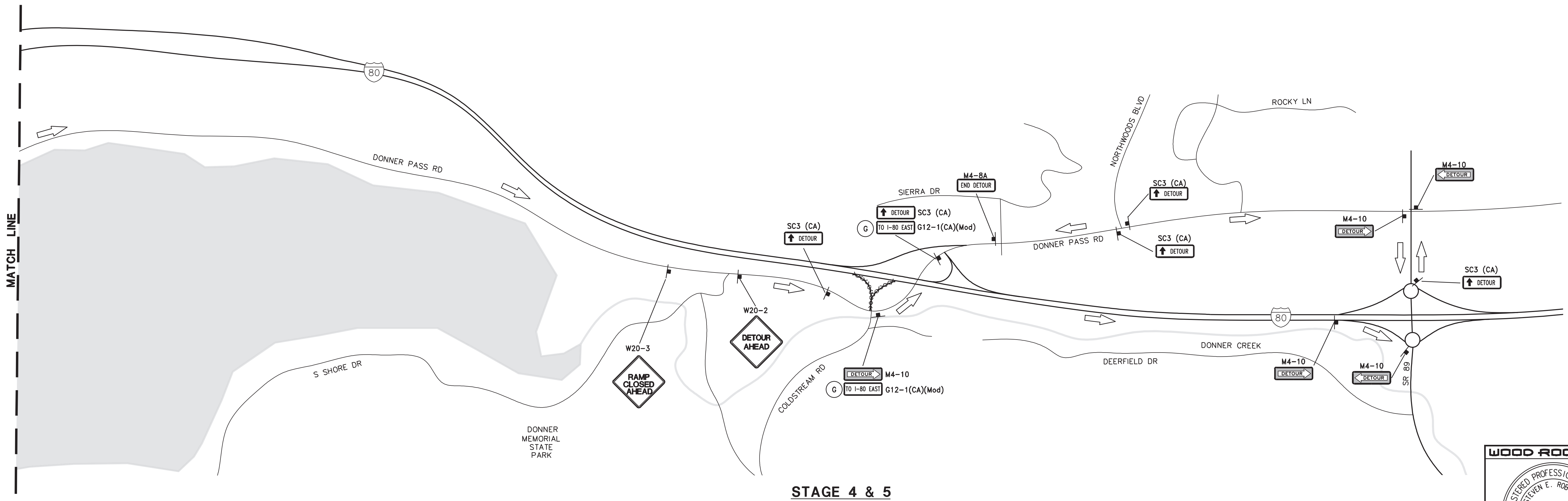
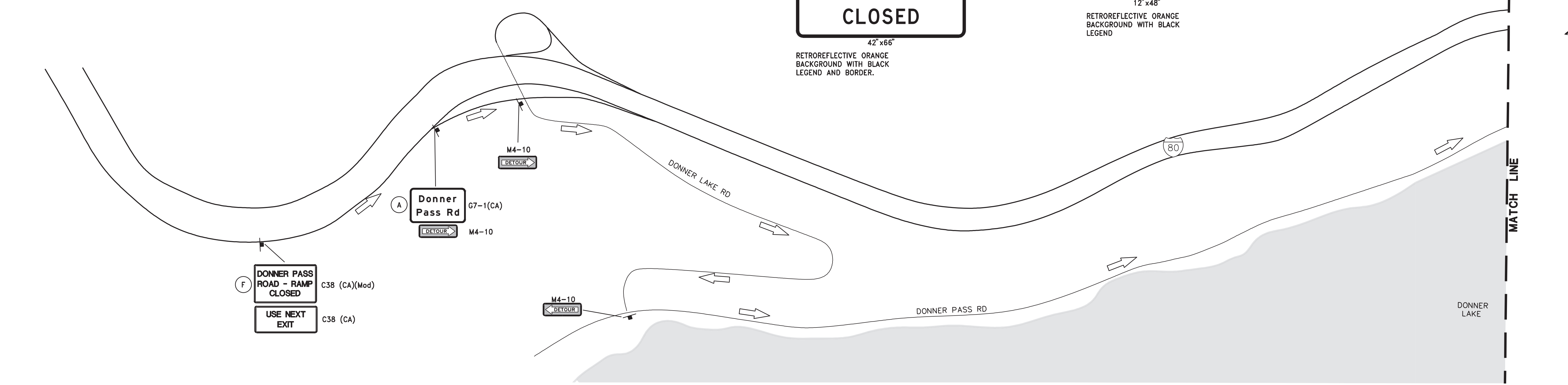

STAGE 4 & 5

WOOD RODGERS
 REGISTERED PROFESSIONAL ENGINEER
 STEVEN E. ROBINSON
 73971
 CIVIL
 STATE OF CALIFORNIA
 DATE: 4/8/2021

DATE: APRIL 2021
 SCALE: H: NTS
 DRAWN BY: F. SAI/K. ALEXANDROVA
 DESIGNED BY: S. ROBINSON
 CHECKED BY: M. RAYBACK

WOOD RODGERS
 BUILDING RELATIONSHIPS ONE PROJECT AT A TIME
 3301 C ST. BLDG. 100-B TEL 916.341.7760
 SACRAMENTO, CA 95816 FAX 916.341.7767

IMPROVEMENT PLANS FOR
COLDSTREAM ROAD ROUNDABOUT
MOTORIST INFORMATION PLAN

TOWN OF TRUCKEE, CALIFORNIA

PROJECT NO. 8661.003
MI-2
 SHT 66 OF 104